

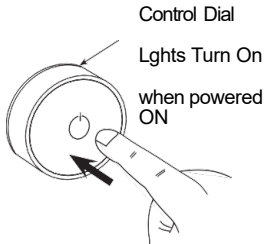

# **TOGO Digital Shower Installation Instructions**

# Togo Shower User Instructions

## Turning the Shower On



Press the control dial to turn the shower on. It will always start with **Outlet 1** active at the default temperature of 38°C. The LED ring around the control dial will glow purple.

## Temperature Setting

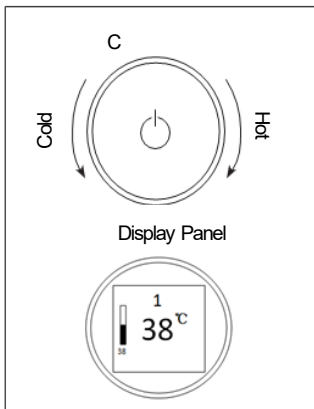

Rotate the control dial clockwise to increase the temperature, and anti-clockwise to decrease it.

- The maximum selectable temperature is 45°C.
- The lowest temperature depends on the temperature of the cold water supply.

The LED ring around the control dial will change colour according to the selected temperature (blue, purple, or red). When a temperature lower than 25°C is selected, the OLED display will show **“COLD”**.

Temperature	Illumination Colour
40°C- 45°C	Red
25°C- 40°C	Purple
0°C- 25°C	Blue

## **Outlet Selection**

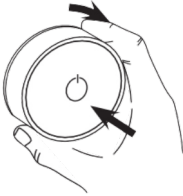

While the shower is running, press and hold the control dial. While holding it down, rotate the dial to select a different outlet.

While selecting the new outlet, the LED ring will change to a different primary colour and the outlet number will appear on the OLED display. Once you release the dial, the selected outlet will activate and the display will revert to the standard layout.

## **Turning the Shower Off**

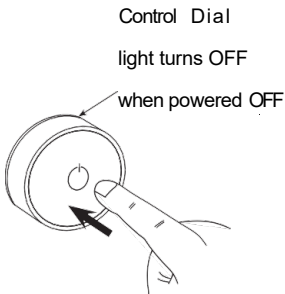

Press the control dial to turn off the water. The LED ring around the dial will turn off.

## Panel Installation Instructions

There are two main types of assembly for the controls: assembly to a backplate or assembly to individual ring backplates.

Follow the appropriate instructions below based on your installation type.

For video demonstrations,

refer to: <https://teddigital.co.uk/videos/>



## **Safety Information**

**Please read these instructions carefully before starting installation and keep in a safe place for future reference.**

This product must be installed by a qualified and competent person in accordance with all relevant current water supply regulations.

All showers requiring an electrical connection must be installed by a qualified person following the latest version of BS 7671 (Wiring Regulations) and certified to current building regulations.

Before any electrical connections are made, the electricity supply must be turned off. Any electrical installation must be carried out only by a qualified person.

This product is not intended for use by persons (including children) with reduced physical, sensory or mental capabilities, or lack of experience and knowledge, unless they are supervised or have been given instructions concerning the safe use of this product.

The shower must not be used with a hot water supply temperature over 75°C.

Hot and cold water supplies should be at balanced pressures of at least 1 bar.

When you first operate the system, the water temperature has been pre-set to 38°C by the factory; however, you can adjust it between 25°C and 45°C during use.

**IMPORTANT: The processor and diverter must be installed in a location that is safely accessible for servicing and maintenance, such as for cleaning filters or checking plumbing connections.**

This processor must not be installed where either the ambient temperature is likely to exceed 40°C or where freezing may occur. Remember that loft spaces can become very cold in winter.

**Cables which are chased into the wall must also be protected by a suitable sized conduit or sheathing to allow removal for servicing and maintenance.**

Surface mounted cables must also be protected by a suitable approved conduit, even in a loft, where there may be a risk of damage from vermin.

The user control is supplied from a low voltage source.

Please check for hidden pipes or cables before drilling any holes.

**Pipe Sizing** Long pipe runs, on both inlet and outlet, will reduce the flow rate at the shower head. 22 mm pipework should be used on inlets and reduced down to 15 mm as close to the processor as possible to reduce pressure losses and help maintain flow rate. To optimise performance, minimise the number of elbows used.

**IMPORTANT:** Do NOT use liquid PTFE or any other sealant on pipe joints as this will void the warranty.

Install full-bore isolating valves on the supply pipes to enable easy maintenance.

All copper pipework must be cross-bonded and connected to an earth point.

### **After Installation**

**IMPORTANT:** After finishing installation, firstly, turn the cold and hot water back on to inspect for water leakage from joints in the water supply connection. If OK, connect the power supply. Then, carry out the COMMISSIONING process before using the shower.

# Pack Components

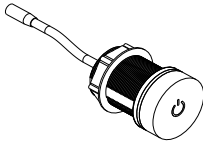

Control Panel x1

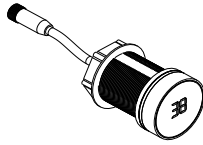

Display Panel x1

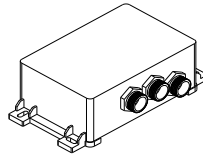

Three Outlet Diverter x1

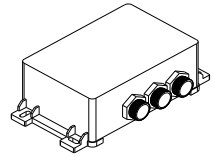

Processor x1

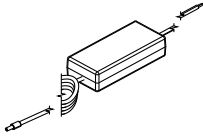

Power Adaptor x1

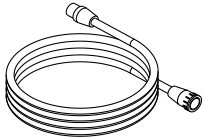

Extension Cable 7.5m<sup>†</sup>



Screw 3.5x25mm x8



Wall Plugs x8

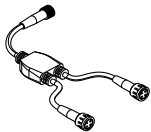

Communication Cable x1

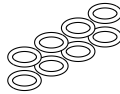

Red O Rings x8

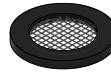

Washer Filter x1



Instruction Book x1

**Note: The filter must be fitted in the diverter inlet. For water supply to processor, we suggest you fit filters when connecting pipes.**

**Red O-rings must be fitted to all female electrical connectors ; they guarantee waterproofing and prevent communication errors.**

**Pipework and plumbing fittings are not included, and should be sourced locally to suit your plumbing configuration and type.**

<sup>†</sup>Additional Extension Cables are available from your retailer if required.

One of the following backplates according to model

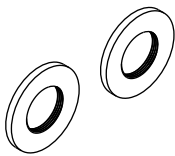

Ring Backplates

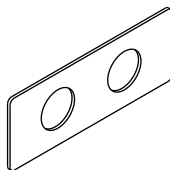

Square Backplate

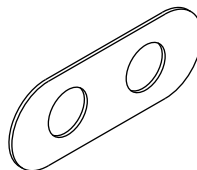

Oval Backplate

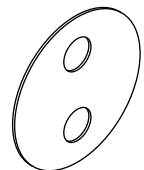

Round Backplate

# Flow Performance

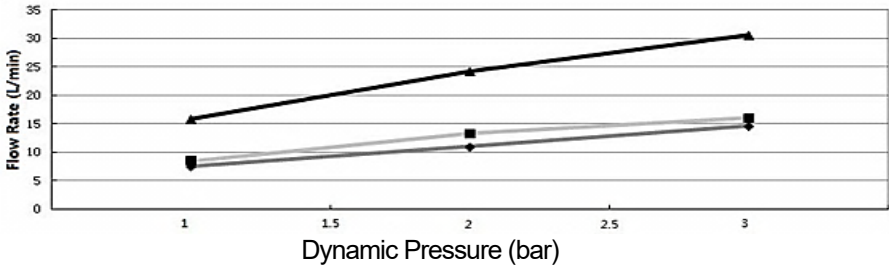

- ◆ Inlet Cold Water Flow Rate
- Inlet Hot Water Flow Rate
- ▲ Outlet Mixed Flow Rate

The performance results above were obtained with inlet cold water temperature of 20°C, and inlet hot water temperature of 65°C at water pressure of 3 bar.

## General Installation Schematic

**IMPORTANT:** The processor must be located for convenient maintenance, not be sealed into the wall.

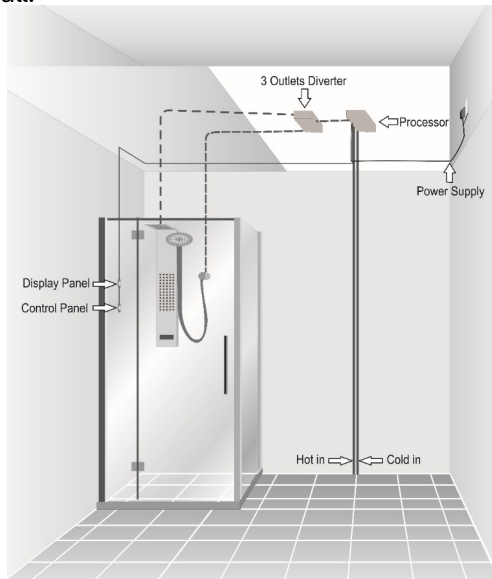

# System Specifications

<b>Electrical Parameters</b>	
Input Supply Voltage	AC110V-230V 50Hz-60Hz
Supply Voltage of Control Panel, Processor & Diverter	DC12V
Maximum Load	18W
<b>Water Pressures</b>	
Inlet Cold Water Static Pressure	1-10bar
Inlet Cold Water Dynamic Pressure	1-5bar
Inlet Hot Water Static Pressure	1-10bar
Inlet Hot Water Dynamic Pressure	1-5bar
Outlet Water Flow Rate (at 3bar)	25L/min
<b>Temperatures</b>	
Maximum Temperature (Factory Preset)	38°C
Maximum Temperature (Setting Range)	25°C-45°C
Minimum Temperature	25°C , Full Cold Water Selectable
High Temperature Protection	49°C
Temperature Stability	+/- 1°C at recommended supply conditions
Hot Water Supply Range	55°C-75°C
Cold Water Supply Range	4°C-25°C
Ambient Temperature	4°C-40°C
Humidity	95% Non Condensing
<b>Times</b>	
Power Off Water Protection Time	≤3s
Cold Water Supply Failure Protection Time	≤2.50s
IP Rating	IPX4
The panels are suitable for installation in the showering area.	

## **Processor Installation Dimension**

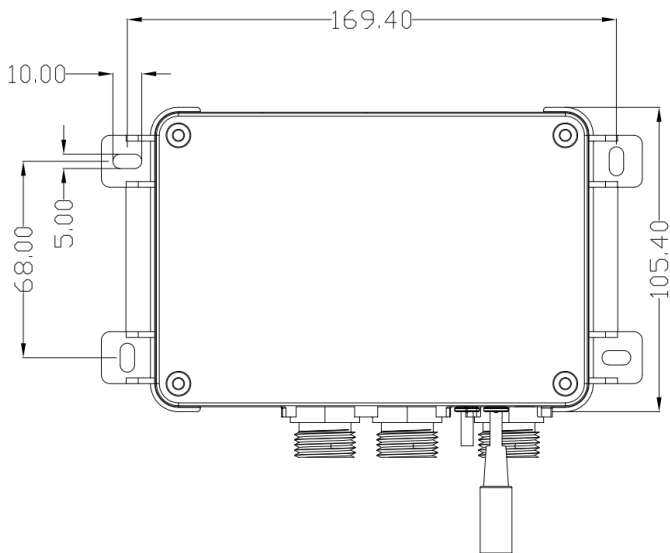

## **Diverter Installation Dimension**

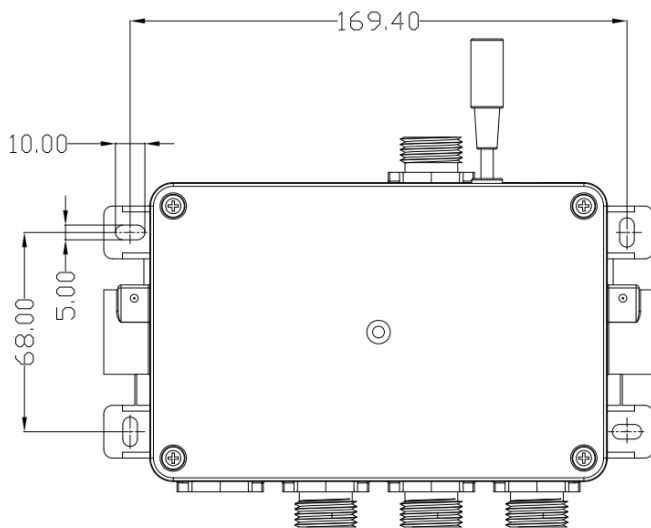

# System Connection Diagram

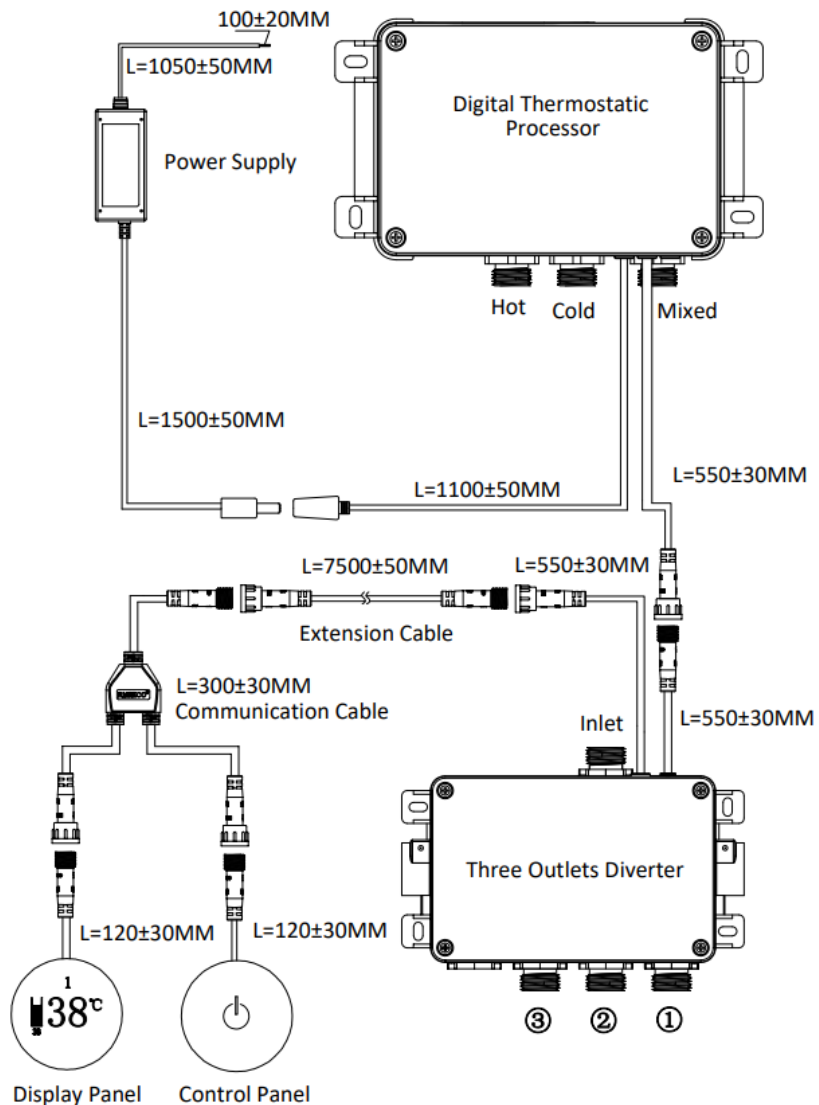

## Processor & Diverter Installation Instruction

Step 1: Mark the fixing holes for Processor and Diverter in the required position.

Step 2: Drill and plug the fixing holes.

Step 3: Secure the Processor and Diverter in position with the fixing screws.

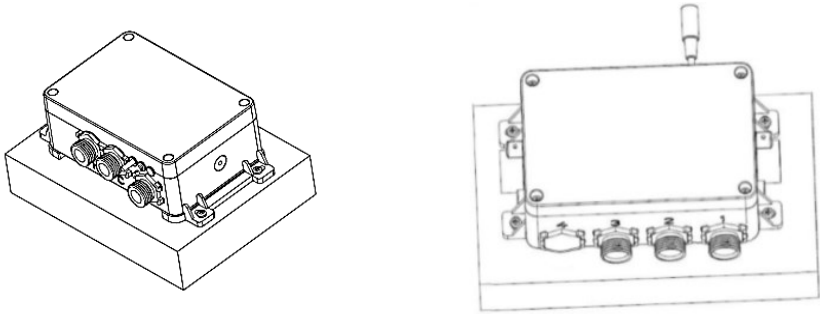

Step 4: Connect water pipes to the Processor and Diverter. (Fit the washer filter before the diverter inlet)

**Important: Do NOT use liquid PTFE or other liquid sealants as this will void the warranty.**

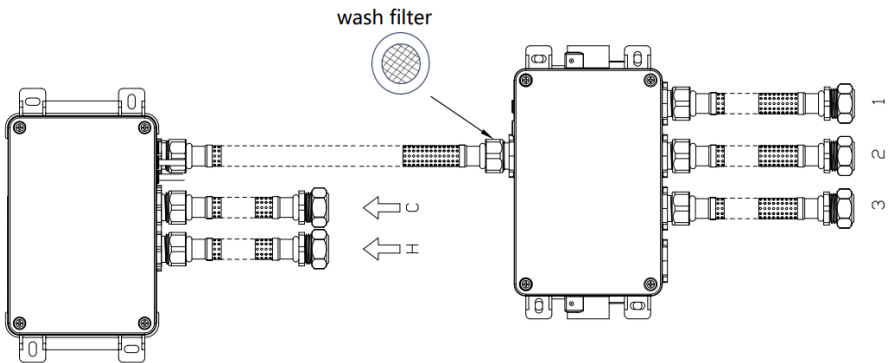

**Please Note** that all connection pipes shown are not supplied and must be obtained by the installer as required.

# Panel Installation Instructions

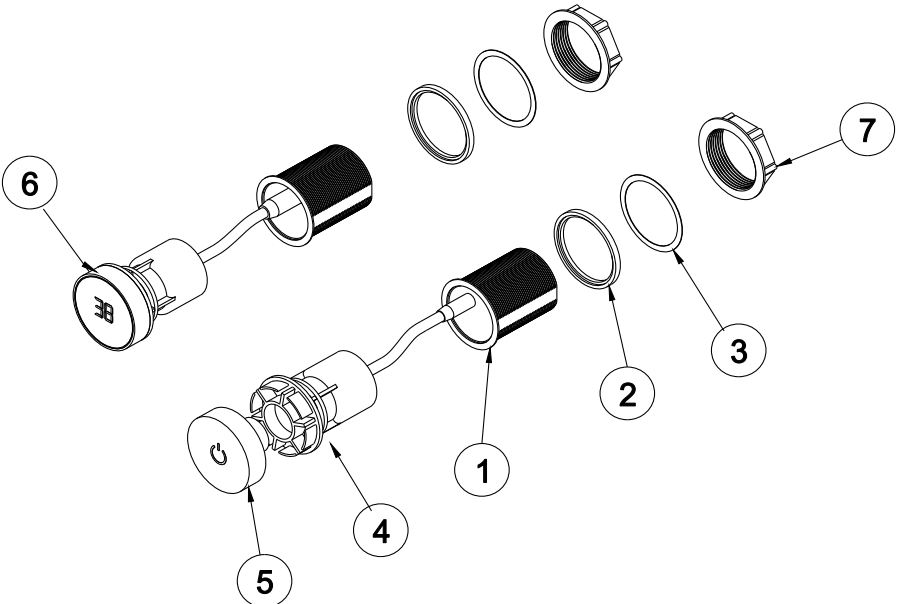

1	Threaded Tube
2	Spacer Ring
3	Washer
4	Control Body
5	Control Dial
6	OLED Screen Assembly
7	Clamp Nut- Optional on RING models

## Assembly to a backplate

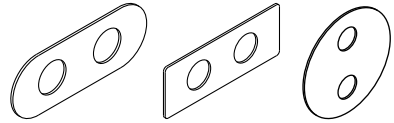

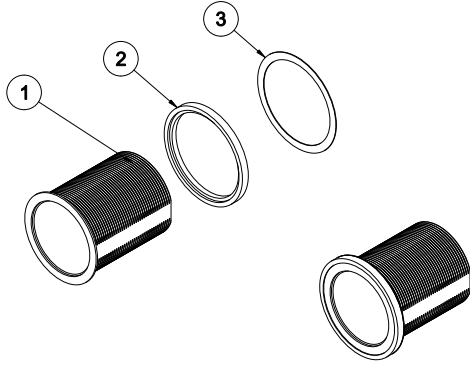
	<p><b>Step1:</b></p> <p>Put The Spacer Ring (2) onto the Threaded Tube (1) followed by the Washer (3)</p>
---	---

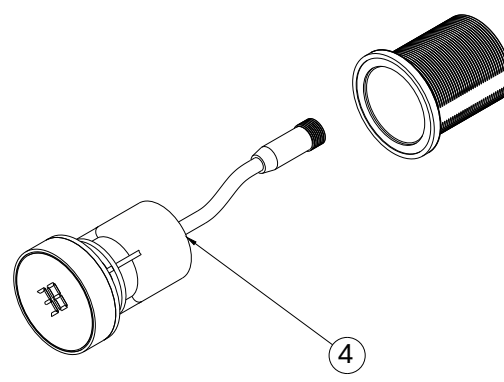
	<p><b>Step2:</b></p> <p>Insert the OLED Screen Assembly (4) onto the Threaded Tube and twist to lock in place.</p>
--	--

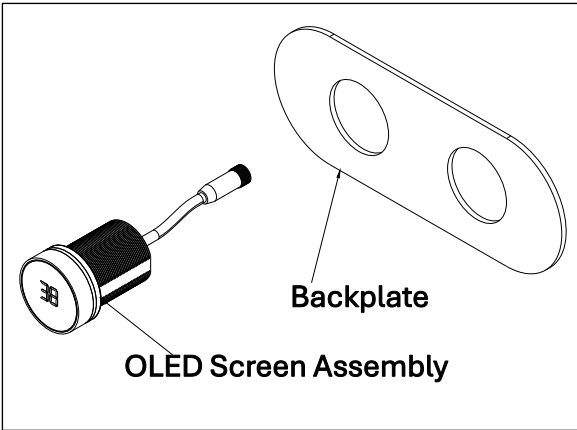

**Step 3:**

Insert the OLED Screen Assembly into the Backplate using the "UP" Sticker as a guide for orientation.

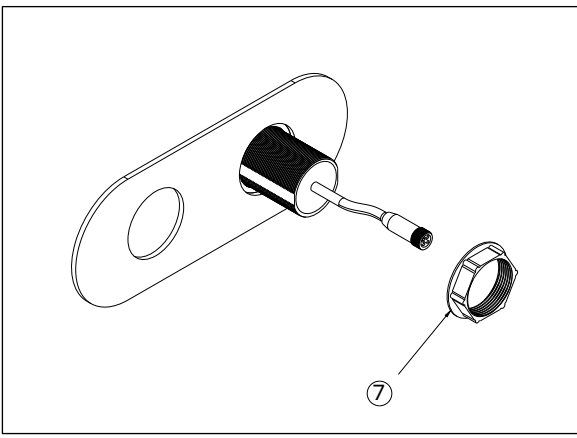

**Step 4:**

Secure the OLED Screen Assembly into the Backplate using Clamp Nut (7).  
**Check the display is in the correct orientation.**

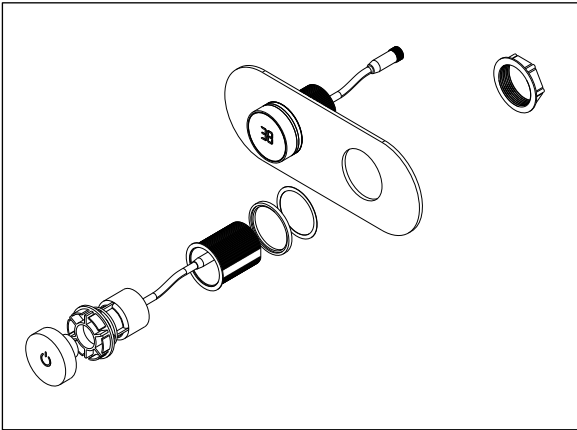

**Step 5:**

Repeat the process above for the control body, press the control dial onto the body.

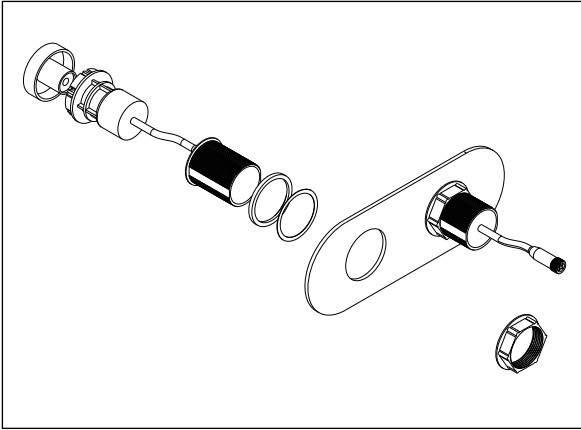

### Step 6:

Secure the Control Body with the Clamp Nut.

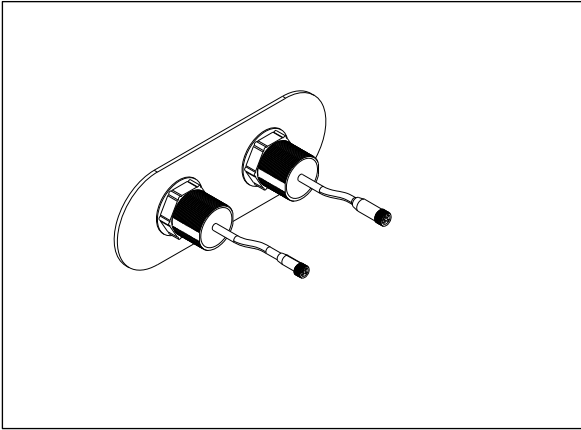

### Step 7:

Repeat the process above for the control body,

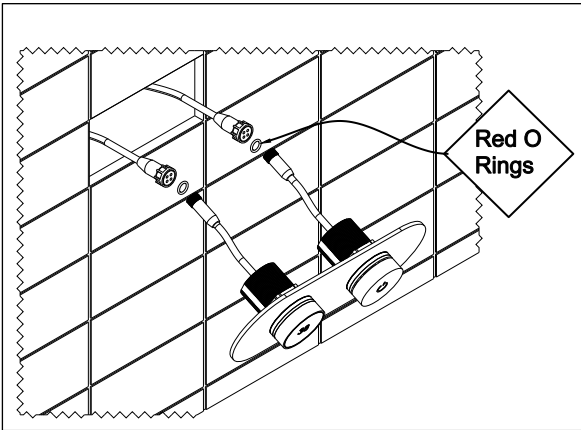

### Step 8:

Connect the Control Plugs to the communication cable sockets installed in the wall-

**! Use the Red O Rings to waterproof the connections**

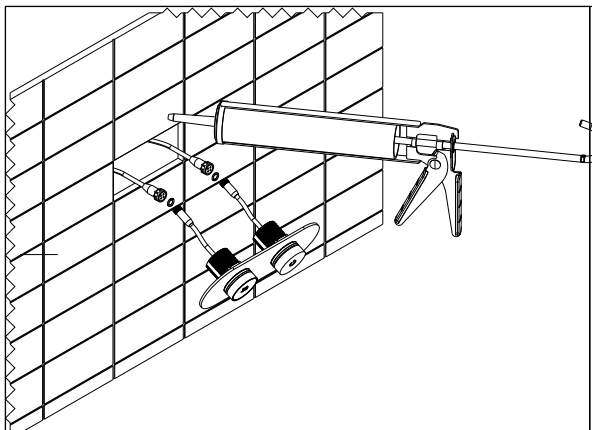

**Step 9:**

Remove the backing from the tape on the backplate and secure to the wall using a suitable silicone adhesive.

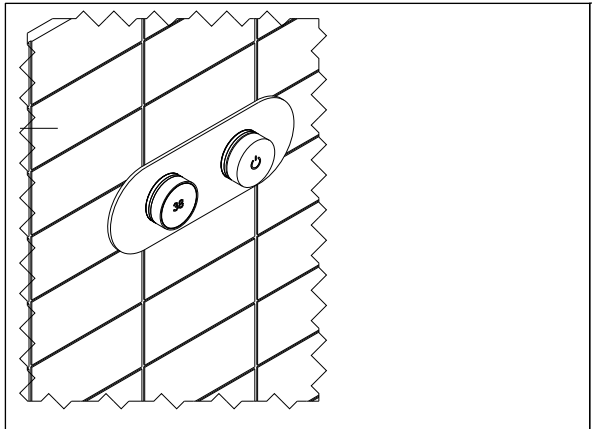

**Step 10:**

Turn On the Unit to ensure connections and Orientation

Tips: The controls use a bayonet connection for easy removal during maintenance. Pull off the control dial or twist the screen to access cables. For technical assistance, contact [info@teddigital.co.uk](mailto:info@teddigital.co.uk) or call 01257 650695.

## **Assembly of Ring backplates**

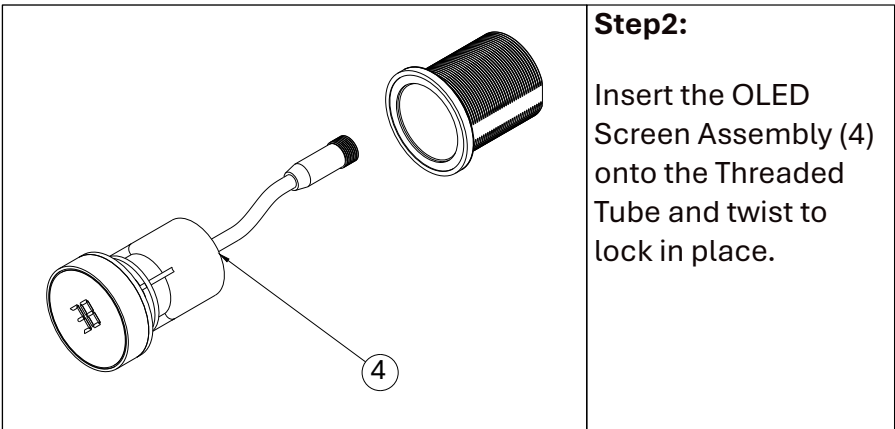
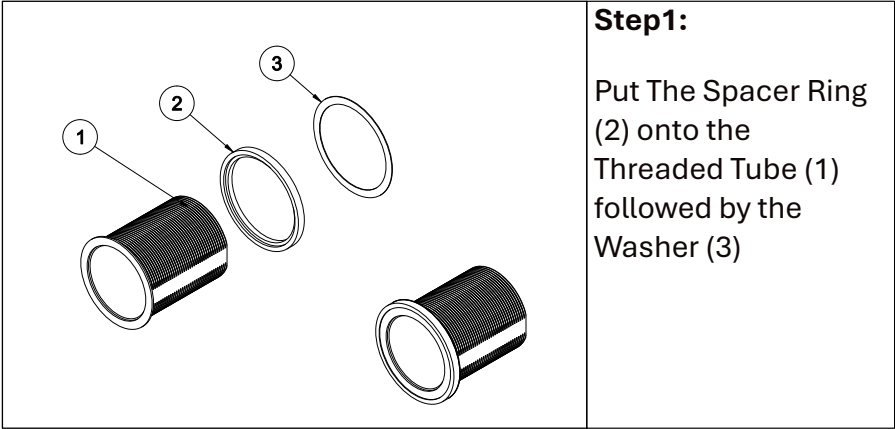

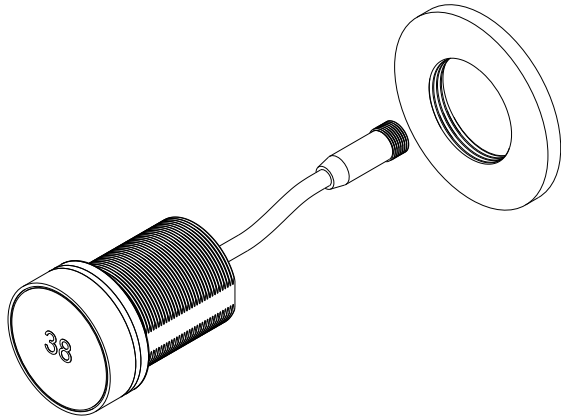

**Step3:**

Screw the Ring Backplate onto the install bracket.

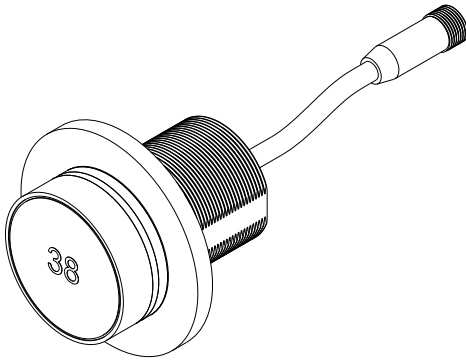

**Step4:**

Hand tighten the Ring Backplate upto the Foam Sealing Ring.

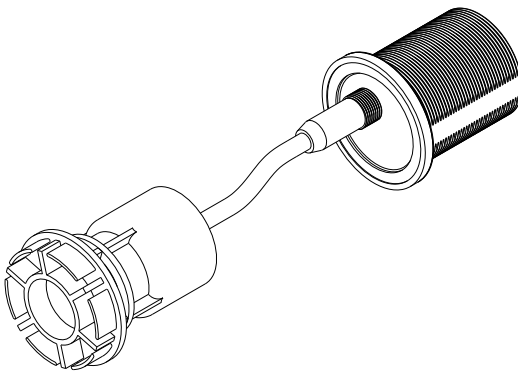

**Step5:**

Repeat Step1 for the install bracket assembly and attach the Control Body with a twisting action to lock in place.

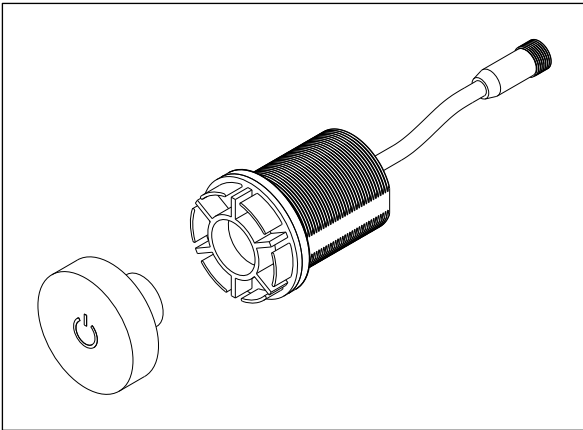

**Step6:**  
Press the On/Off/  
Control Knob onto  
the onto the control  
body.

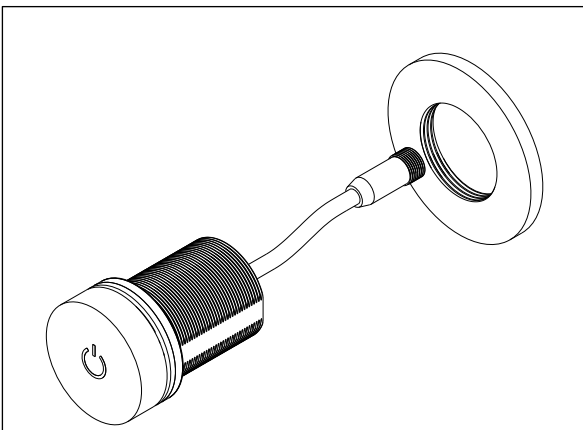

**Step7:**  
Screw the Ring  
Backplate onto the  
install bracket.

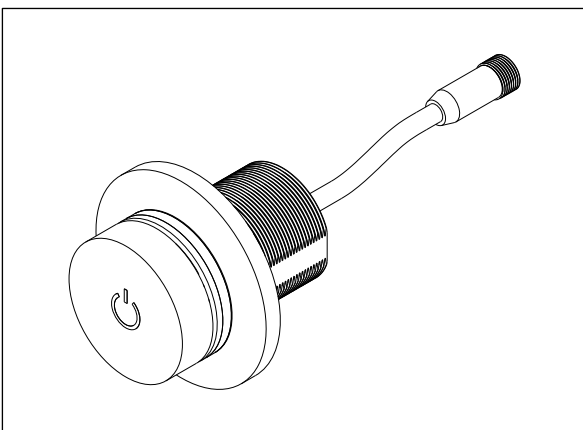

**Step8:**  
Hand tighten the  
Ring Backplate upto  
the Foam Sealing  
Ring.

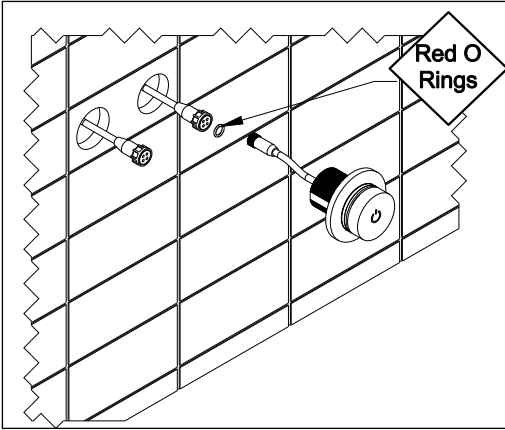

**Step9:**

Connect the Control Panel to the Communication Cable

**! Use the Red O Rings to waterproof the connections**

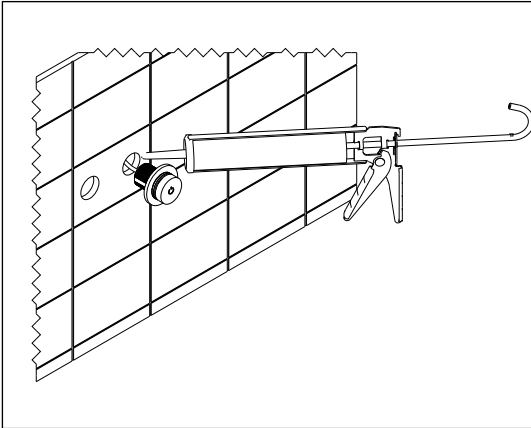

**Step10:**

If you have access to the back use a clamp nut to hold in place otherwise, apply a bead of silicone to the Backplate Ring to seal and hold the unit in place,

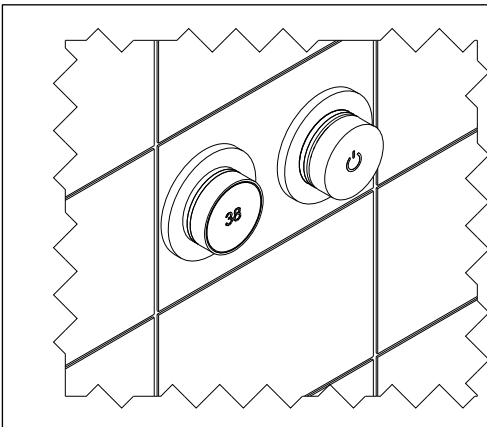

**Step11:**

Repeat Step10 for the Display Control

**! Turn On the Unit to check operation and orientation.**

# Commissioning

Before using the shower for the first time, the installer needs to check that the water/plumbing connections are correct. Follow this simple commissioning procedure after completing the plumbing connections:

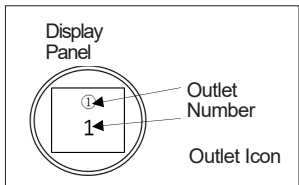
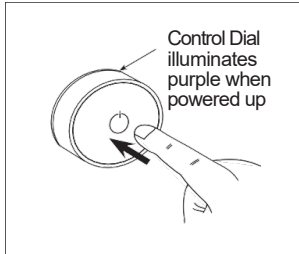

Icons	X	1	2	3
Light Flashing	Orange	Red	Green	Blue

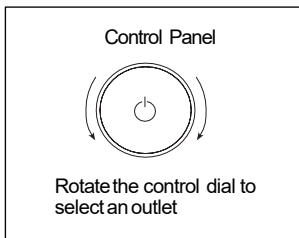

1. Check carefully for leaks around the processor and diverter.
2. Turn on the mains power to the system, but make sure the SHOWER IS OFF.
3. Press and hold the control dial until the light ring flashes ORANGE, then let go.
4. On the screen there will be a (1) in a circle, and a large X.
5. Rotate the dial one notch to the right so a large 1 replaces the X. This tells the system that Outlet 1 is active.
6. Press the dial to save.
7. On the screen there will be a (2) in a circle, and a large X.
8. Rotate the dial one notch to the right so a large 2 replaces the X. This tells the system that Outlet 2 is active.
9. Press the dial to save.
10. On the screen there will be a (3) in a circle, and a large X.  
 If Outlet 3 is to be used: 11a. Rotate the dial one notch to the right so a large 3 replaces the X. This tells the system that Outlet 3 is active. Press the dial to save.  
 If Outlet 3 is not to be used: 11b. Just press the dial to save with the X visible.
12. Check the plumbing connections for leaks again, then the shower is ready for use!

<b>Fault Code</b>	<b>Possible Causes</b>	<b>Fault Remedy</b>
COLD INLET FAILURE	No cold water	Check cold water supply
	Hot water pressure is too high	Adjust inlet hot water pressure ( $\leq 10$ bar)
	Processor failure	Replace processor (This should be replaced by the factory; call after-sales service)
TEMPERATURE CONTROL FAILURE	Outlet water temperature sensor failure	Replace processor (This should be replaced by the factory; call after-sales service)
INLET TEMPERATURE SENSOR FAILURE	Hot water temperature sensor failure	Replace processor (This should be replaced by the factory; call after-sales service)
OUTLET SWITCH FAILURE	Motor failure	Replace processor (This should be replaced by the factory; call after-sales service)
CONNECTION ERROR	Cable is not connected	Ensure the data connection cable between the panels and the processor is installed correctly. Press the dial to clear the fault, then press again to power on the shower
	Pins are damaged	Check communication cable or replace it.
INLET HOT WATER TEMPERATURE OVER 85°C	Inlet hot water temperature is over 85°C	Adjust inlet hot water temperature ( $< 85^{\circ}\text{C}$ )

<b>Fault Code</b>	<b>Possible Causes</b>	<b>Fault Remedy</b>
INLET HOT WATER TEMPERATURE IS TOO LOW	No hot water	Ensure hot water supply to the processor is installed and that your heating system is working correctly
	Inlet hot water temperature is too low	Adjust inlet hot water temperature ( $\geq 55^{\circ}\text{C}$ )
	Check valve in hot water inlet failure & cold water pressure is too high	Check the valve to ensure it is clean and there are no impurities inside. Replace processor (This should be replaced by the factory; call after-sales service)
	Inlet hot water pipe is too long, so mixed water cannot reach pre-set temperature within 2 minutes	Restart the unit (for multiple times if needed)
INLET COLD WATER TEMPERATURE IS TOO HIGH	Inlet cold water temperature is too high	Adjust inlet cold water temperature ( $\leq 25^{\circ}\text{C}$ ). Adjust temperature on panel until it displays "COLD"
	Check valve in cold water inlet failure & hot water pressure is too high	Check the valve to ensure it is clean and there are no impurities inside. This should be replaced by the factory; call after-sales service

## Warranty

### TED Digital Warranty Terms and Conditions

At TED Digital, the warranty is straightforward, customer-friendly, and requires no registration. It applies automatically from the date of purchase, provided proof of purchase (e.g., receipt or invoice) is retained for claims. The warranty covers manufacturing defects in materials and workmanship under normal use and installation by a qualified professional. It excludes damage from misuse, abuse, neglect, accidents, improper cleaning, improper installation, unauthorised modifications, or normal wear and tear.

#### Warranty Periods

- Digital components (e.g., processors, controls, electronic parts): **5 years.**
- Consumable items (e.g., hoses, washers, seals, replaceable parts): **1 year.**
- Accessories (e.g., shower heads, handsets, metal parts of controls): **10 years.**

#### Coverage Details

- First 1 year: Covers parts and reasonable labour costs for repairs or replacements.
- After 1 year: Covers parts only; labour and installation costs are the customer's responsibility.
- “Dead on Arrival” (DOA) claims: Covers parts replacement if the product is faulty on initial setup. Labour costs are covered only if the product was fully installed by a qualified professional, handed over to the end customer, and confirmed operational before the fault was reported. Labour claims are excluded for incomplete or improper installations.

## **How to Make a Claim**

1. Contact customer support with issue details, product model, and proof of purchase.
2. Provide photos, diagnostic information, or return the faulty item for inspection if requested.
3. If validated, TED Digital will repair, replace, or refund (limited to the original purchase price) at its discretion.
4. Shipping costs for returns may be reimbursed if the claim is approved.

## **Exclusions and Limitations**

- Non-transferable; applies only to the original purchaser.
- Applicable to installations within the United Kingdom only.
- Does not cover consequential damages, loss of use, or third-party costs.
- Commercial use may have adjusted terms—contact for details.
- Warranty may be voided if the product is tampered with or serviced by unauthorised parties.

This policy aligns with UK consumer rights and supersedes prior versions. For questions, contact support at

[info@teddigital.co.uk](mailto:info@teddigital.co.uk).

Please do not open or tamper with the processor unit, as this will invalidate the warranty.

